

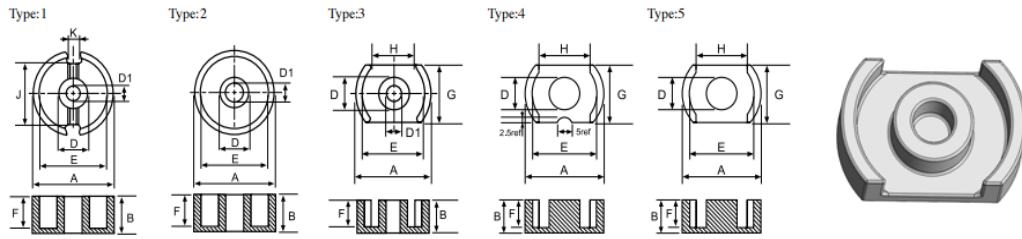

湖南创一电子科技股份有限公司
CYGE ELECTRONIC TECHNOLOGY (HUNAN) CO.,LTD

Type : CUT Cores



| 规格 Type | 尺寸Dimensions (mm) | | | | | | | | | | 图号 Fig. |
|-----------------------|-------------------|-------------|--------------|--------------|-------------|--------------|-------------|-------------|--------------|--------------|------------|
| | A | B | D | E | F | J | K | D1 | G | H | |
| CUT-14.0-6.09-4.18 | 14.00 ± 0.25 | 4.18 ± 0.08 | 6.09ma x | 11.60mi n | 2.79min | 9.50 ± 0.60 | 3.30 ± 0.60 | - | 9.55 ± 0.15 | 7.60min | 1 + 3 |
| CUT-14.0-6.09-4.18CH | 14.00 ± 0.25 | 4.18 ± 0.08 | 6.09ma x | 11.60mi n | 2.79min | 9.50 ± 0.60 | 3.30 ± 0.60 | 3.10 ± 0.07 | 9.55 ± 0.15 | 7.60min | 1 + 3 |
| CUT-17.90-7.40-5.30 | 17.90 ± 0.30 | 5.30 ± 0.07 | 7.40 ± 0.15 | 15.25 ± 0.25 | 3.80 ± 0.10 | 11.55 ± 0.30 | 3.20 ± 0.30 | 3.02 ± 0.07 | 11.90 ± 0.20 | 10.50mi n | 1 + 3 |
| CUT-22.86-9.90-5.53 | 22.86 ± 0.45 | 5.53 ± 0.25 | 9.90ma x | 17.93mi n | 3.63min | - | - | 5.08 ± 0.10 | 15.24 ± 0.25 | 13.21mi n | 2 + 3 |
| CUT-5.70-2.40-1.60 | 5.70 ± 0.15 | 1.60 ± 0.10 | 2.40 ± 0.10 | 4.70 ± 0.20 | 1.03 ± 0.10 | - | - | - | 4.13 ± 0.15 | 2.75min | 5 |
| CUT-14.00-6.09-4.18 | 14.00 ± 0.25 | 4.18 ± 0.06 | 6.09ma x | 11.60mi n | 2.79min | - | - | - | 9.55 ± 0.15 | 7.60min | 5 |
| CUT-14.00-6.09-4.18CH | 14.00 ± 0.25 | 4.18 ± 0.08 | 6.09ma x | 11.60mi n | 2.79min | - | - | 3.10 ± 0.07 | 9.55 ± 0.15 | 7.60min | 3 |
| CUT-17.90-7.40-5.30 | 17.90 ± 0.30 | 5.30 ± 0.10 | 7.40 ± 0.15 | 15.25 ± 0.25 | 3.80 ± 0.10 | - | - | - | 11.90 ± 0.20 | 10.50mi n | 5 |
| CUT-17.90-5.40-5.30CH | 17.90 ± 0.30 | 5.30 ± 0.07 | 7.40 ± 0.15 | 15.25 ± 0.25 | 3.80 ± 0.10 | - | - | 3.02 ± 0.07 | 11.90 ± 0.20 | 10.50mi n | 3 |
| CUT-21.60-9.40-4.10 | 21.60 ± 0.40 | 4.10 ± 0.25 | 9.40 ± 0.20 | 17.50 ± 0.30 | 2.35 ± 0.15 | - | - | - | 15.20 ± 0.25 | 10.95ref | 5 |
| CUT-21.60-9.20-6.70 | 21.60 ± 0.30 | 6.70 ± 0.10 | 9.20 ± 0.20 | 18.20 ± 0.20 | 4.75 ± 0.15 | - | - | 4.55 ± 0.10 | 14.80 ± 0.20 | - | 3 |
| CUT-22.90-9.75-5.55 | 22.90 ± 0.45 | 5.55 ± 0.15 | 9.75 ± 0.15 | 18.25 ± 0.30 | 3.75 ± 0.15 | - | - | - | 15.20 ± 0.25 | 10.95ref | 5 |
| CUT-30.20-12.50-9.50 | 30.20 ± 0.50 | 9.50 ± 0.10 | 12.50 ± 0.20 | 24.70 ± 0.40 | 6.60 ± 0.10 | - | - | - | 20.50 ± 0.25 | 16.80 ± 0.25 | 5 |
| CUT-30.0-13.2-7.0 | 30.00 ± 0.50 | 7.00 ± 0.10 | 13.20 ± 0.20 | 25.70 ± 0.40 | 4.70 ± 0.15 | - | - | - | 20.30 ± 0.25 | 17.80mi n | 5 |
| CUT-33.20-13.50-5.56 | 33.20 ± 0.40 | 5.56 ± 0.15 | 13.50 ± 0.25 | 26.60 ± 0.40 | 3.25 ± 0.15 | - | - | - | 23.70 ± 0.30 | 18.00mi n | 4 |
| CUT-33.20-13.50-6.10 | 33.20 ± 0.50 | 6.10 ± 0.15 | 13.50 ± 0.20 | 26.60 ± 0.40 | 3.20 ± 0.15 | - | - | - | 23.70 ± 0.30 | 18.20mi n | 5 |
| CUT-33.20-13.40-9.45 | 33.20 ± 0.50 | 9.45 ± 0.15 | 13.40 ± 0.20 | 26.80 ± 0.40 | 6.65 ± 0.15 | - | - | - | 23.70 ± 0.30 | 18.20mi n | 5 |
| CUT-39.80-16.00-6.75 | 39.80 ± 0.50 | 6.75 ± 0.15 | 16.00 ± 0.25 | 33.30 ± 0.50 | 4.35 ± 0.15 | - | - | - | 28.30 ± 0.35 | 21.00mi n | 5 |



湖南创一电子科技股份有限公司
CYGE ELECTRONIC TECHNOLOGY (HUNAN) CO.,LTD

| | | |
|--|------|--|
| | 磁芯参数 | |
|--|------|--|

| 规格 Type | C1(mm ⁻¹) | Le(mm) | Ae (mm ²) | Ve (mm ³) | Wt (g/set) | 图号 Fig. |
|-----------------------|-----------------------|--------------|--------------------------|--------------------------|---------------|------------|
| CUT-14.0-6.09-4.18 | 0.71 | 20.9 | 29.2 | 610 | 2.91 | 1+3 |
| CUT-14.0-6.09-4.18CH | 0.91 | 21.1 | 23.3 | 492 | 2.66 | 1+3 |
| CUT-17.90-7.40-5.30 | 0.67 | 27.2 | 40.6 | 1110 | 5.4 | 1+3 |
| CUT-22.86-9.90-5.53 | 0.47 | 28.6 | 61 | 1745 | 11.94 | 2+3 |
| CUT-5.70-2.40-1.60 | 1.86 | 8.81 | 4.74 | 41.78 | 0.2 | 5 |
| CUT-14.00-6.09-4.18 | 0.7 | 21 | 29.9 | 627.9 | 2.91 | 5 |
| CUT-14.00-6.09-4.18CH | 1.02 | 22.5 | 22 | 495 | 2.66 | 3 |
| CUT-17.90-7.40-5.30 | 0.72 | 29.75 | 41.14 | 1224 | 5.52 | 5 |
| CUT-17.90-5.40-5.30CH | 0.78 | 27.2 | 35 | 952 | 6 | 3 |
| CUT-21.60-9.40-4.10 | 0.42 | 25.82 | 61.11 | 1578 | 8.5 | 5 |
| CUT-21.60-9.20-6.70 | 0.69 | 36.27 | 52.83 | 1916 | 4.9 | 3 |
| CUT-22.90-9.75-5.55 | 0.54 | 35.1 | 64.9 | 2278 | 12.14 | 5 |
| CUT-30.20-12.50-9.50 | 0.45 | 50.2 | 111 | 5572 | 30.96 | 5 |
| CUT-30.0-13.2-7.0 | 0.47 | 42.5 | 90,65 | 3853 | 11.21 | 5 |
| CUT-33.20-13.50-5.56 | 0.28 | 36.7 | 131.9 | 4836 | 25.1 | 4 |
| CUT-33.20-13.50-6.10 | 0.24 | 33.84 | 143.9 | 4869 | 37.12 | 5 |
| CUT-33.20-13.40-9.45 | 0.36 | 52.62 | 144.6 | 7608 | 39.2 | 5 |
| CUT-39.80-16.00-6.75 | 0.27 | 44 | 161 | 7084 | 40.6 | 5 |